

A.

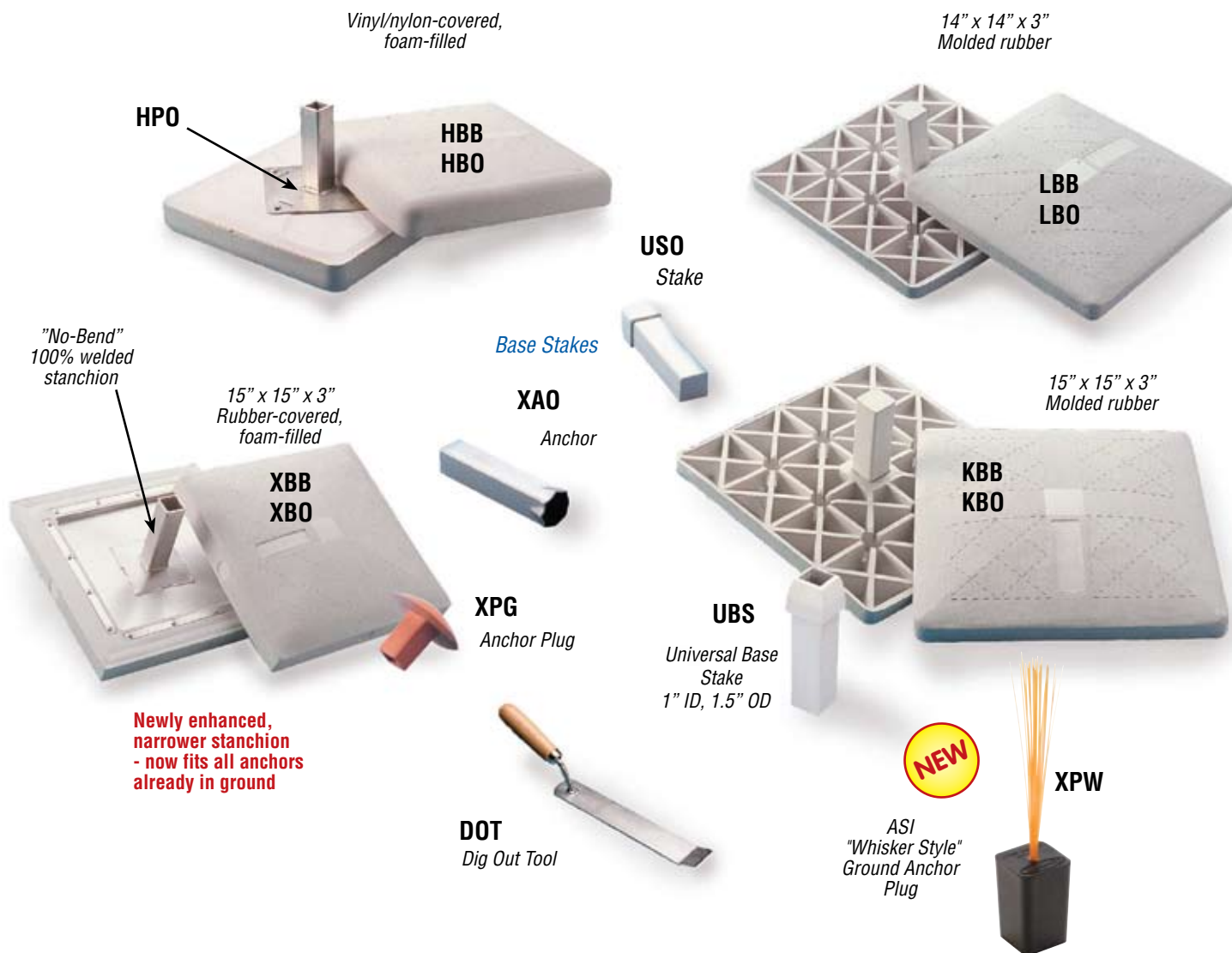

A. Bases.

XBB - Top quality "Professional/Hollywood" Base Set. 15" x 15" x 3" regulation size with universal stanchion - fits both 1" male or 1-1/2" female ground anchors. Includes 3 XAO ground anchors & 3 XPG anchor plugs.

XBB-1 - One XBB Base with anchor & plug.

XBO - XBB Bases only. No anchors or plugs.

XBO-1 - One XBB Base. No anchor or plug.

HBB - 15" x 15" x 3" Anchor Base Set. Bolt-on metal base plate w/universal stanchion. Includes 3 XAO anchors & 3 XPG plugs.

HBO - HBB Bases only. No anchors or plugs.

HPO - Metal baseplate for HBB.

KBB - 15" x 15" x 3" Molded Rubber Base Set with USO rubber base stakes. Includes 3 XAO anchors & 3 XPG plugs.

KBO - KBB Bases only. No anchors or plugs.

LBB - As above KBB in 14" x 14" x 3" youth size.

LBO - LBB Bases only. No anchors or plugs.

Base Anchors and Stakes.

XAO - Steel Ground Anchors. 1-1/2" female opening x 8" length. For all bases/plates that utilize a 1-1/2" anchor system. Sold in set/3.

XPG - Rubber Ground Anchor Plugs. Keeps dirt out of anchors. Sold in sets/3.

USO - Solid Rubber Base Stake. 7" x 1-1/2" square. Sold per each.

UBS - Universal Rubber Base Stake. 1" sq. hollow center for use with 1" sq. male or 1-1/2" sq. female ground anchors. 7" length. Sold per each.

DOT - Dig Out Tool. Removes loose dirt around ground anchors. Wood handle.

XPW - ASI "Whisker Style" Rubber Ground Anchor Plugs with Orange Bristles. Locate anchors quickly. 1-1/2" rubber plugs. Sold per each. Patent # 6,142,882. MFG under license.

WARNING: ASI advises that sliding into a baseball base represents a clear and present danger. Injuries may occur.